

LED Flood Light XFL Series

Project:	
Catalog#:	
Approved by:	

Features

- LED: Lumileds
- Color Temperature: 5000K (cool white)
- Color Rendering Index (CRI): > 80
- Long LED life; $L_{70} > 60,000$ hours. L_{70} hours are IES TM-21-11 calculated hours.
- Rated for Ambient Temperatures up to 40°C/104°F
- Power Factor (PF) > 0.9
- Total Harmonic Distribution (THD) < 20%
- Input Voltage: 120 – 277V; 50/60 Hz
- Dimmable: 0-10Vdc
- Beam Angle: 90°x120° (NEMA 7x7)
- Ultra-durable Powder Coat Paint
- Standard Color Bronze
- UL/cUL Listed
- IP65
- Warranty: 5 years

Applications

- Security
- Signs
- Building Facades
- Displays



XFL-5080-LED-MV-TR



XFL-5220-LED-MV

Mounting Options

- '-TR' in model configuration for trunnion.
- Slip Fitter (XFL-SF) can be used to attach fixture to a 2 3/8" OD tenon (2-inch pipe). Fits '-TR' models only.



Dimensions

Model	A	B	C	D	E	Effective Projected Area (sf)	Weight
XFL-5080	12 5/8	9 7/8	12 3/8	13 1/2	3 7/16	Top 1.04 Side 0.28 Front 0.36	12.0 lbs
XFL-5220	12 5/8	17	19 1/2	13 1/2	3 5/8	Top 1.79 Side 0.39 Front 0.36	25.0 lbs

All dimensions in inches

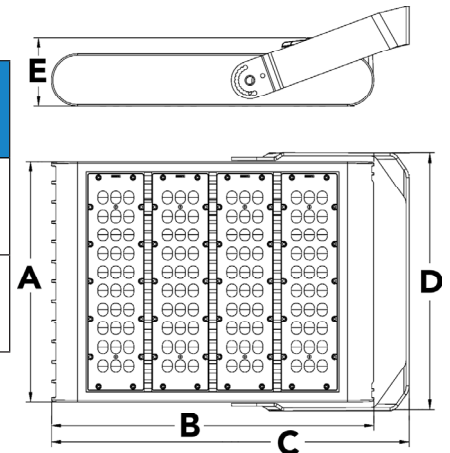

XFL Series LED Flood Light

Model	CCT	Input Power	Lumen Output	Efficacy	Voltage	Mounting	Comparable to HID
XFL-5080-LED-MV-TR	5000K	79W	10,342	131 LPW	120-277V	Trunnion	200W
XFL-5220-LED-MV ¹	5000K	229W	26,731	117 LPW	120-277V	Yoke	750W

¹Limited quantities available

LED Flood Light XFL Series

Project:	
Catalog#:	
Approved by:	

Photometrics

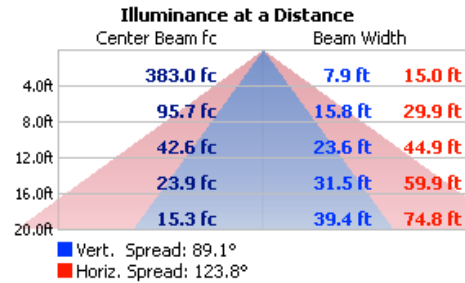
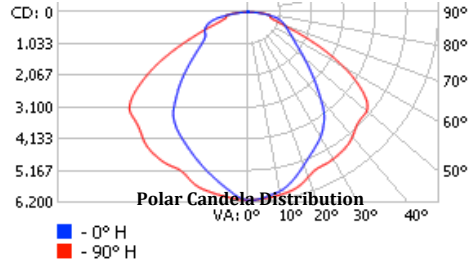
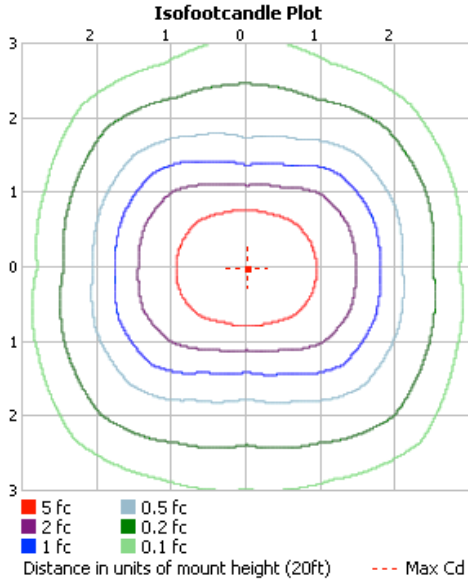

Height	Center Beam Footcandle (fc)		Beam Spread (ft.)	
	080 Series	220 Series	Horizontal	Vertical
4 Ft.	199	575	15	8
8 Ft.	50	144	30	16
12 Ft.	22	64	45	24
16 Ft.	12	36	60	32
20 Ft.	8	23	75	39
Beam Angle				
			124°	89°

Accessories (Sold Separately)

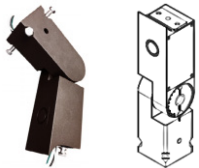

XFL-SF: Slip Fitter
2 3/8" OD tenon (2-inch pipe).
Compatible with XFL-TR & all
XAL Models.

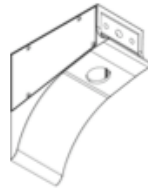

XAL-ARM: 6" Long Mounting Arm.
Fits '-TR' models only.

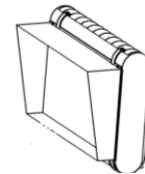

XHGS-L: Half Glare Shield (220W)