

Replace 200W and 250W MH lamps for wall packs. Water/dust resistant. Uses 76% less energy than MH. 350° rotatable base puts light where you need it.

Color: White

Weight: 2.2 lbs

Project:

Type:

Prepared By:

Date:

Driver Info

Watts 60W
Color Temp 5000K (Daylight)
Lumens 9,300
Efficacy 155 LPW
Color Accuracy 80 CRI
L70 Accuracy 50,000

LED Info

Input Voltage 100-277V
Power Factor 0.9
Flicker <30%
THDi <20%
R9

Technical Specifications

Listings

UL Listed:

Yes

UL Classified:

Yes

FCC:

Yes

Rohs:

Yes

CEC Status:

Lawful for sale in California

DLC Qualified:

Yes

DLC Listed:

This product is on the Design Lights Consortium (DLC) Qualified Products List and is eligible for rebates from DLC Member Utilities. DLC Product Code: PLFRALVVSM40

Description

Lamp Type:

HID

Bulb Type:

Wall Pack

Base Type:

EX39, Mogul Base

Construction

Operating Temperature:

-20 - 40°C

Bare Lamp Illuminated Length (inches):

7.56"

MOL (inches):

10.67"

MOD (inches):

3.62"

Minimum Compartment Size (inches):

Length: 7.87"
Width: 7.87"
Height: 11.81"

LED Characteristics

Lifespan:

50,000-hour LED lifespan based on IES LM-70 results

Technical Specifications

Dimmable:

No

Optical

Beam Angle:

180°

Other

Warranty:

5-years

Technical Specifications (continued)

Other

Accessories:

Surge protector available. Click [here](#) for surge protector accessory. Sold separately.

Shipping Information

Case Qty:

12

Case Dimensions:

16.73 x 12.68 x 12.6

Pallet Quantity of Pieces:

144

Pallet Dimensions:

27.32 x 35.43 x 42.52

Dimensions

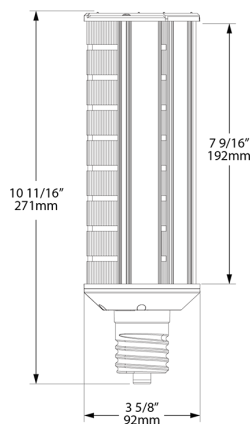

Features

- HID REPLACEMENT** - Replacement for conventional HID lamps
- BALLAST BYPASS** - Internal driver eliminates the need for external driver or ballast
- COMPACT DESIGN** - Allows the lamp to fit in most fixtures
- INSTALLATION ORIENTATION** - Lamps can be installed universally Base up, down or sideways
- HEAT DISSIPATION** - Thermal technology extends lifespan
- WATER & DUST RESISTANT** - Ideal for outdoor fixtures
- ENCLOSED FIXTURE RATED** - May be used in enclosed and open fixtures
- ENERGY SAVINGS** - Uses 76% less energy than traditional lamps
- MERCURY FREE** - Environmentally friendly vs fluorescent technologies
- 350° ROTABLE BASE** - Direct light where needed

Ordering Matrix

Family	Lamp Power	Orientation	Base Type	CRI/Color Temp	Installation Type	Lamp Type
HID	60	H	EX39	850	BYP	WP
	40 = 200W 60 = 250W	H = Horizontal	EX39 = EX39	830 = 3000K 840 = 4000K 850 = 5000K	BYP = Bypass	WP = Wall Pack