



SB-TP LED Tri-Proof linear Light Series



OVERVIEW:

DESCRIPTION

The SB-TP series LED Luminaires, built from impact resistant polycarbonate and stainless steel clips, are ideal for harsh environmental applications. It combines waterproof, corrosion proof and dust proof protection with LED performance. Long life SMD chips provide high brightness, high lumen maintenance and excellent efficiencies in a vapor proof fixture.

Built in UV protection provides excellent weather resistance and protects against yellowing.

The SB-TP LED series is designed for general area lighting, cold storage, utility, stairwell lighting and harsh environments.

- Efficiency: Up to 137 LPW
- Delivered Lumens: Up To 5,250 lumens
- Input Power: 20W, 40W
- CCT: 3000K, 4000K, and 5000K
- Power factor > 0.90
- UL/cUL DLC, FCC Wet Location Listed, IP65

- CRI: Minimum 83
- Input Voltage: 100-277V or 200-480V
- 0-10V dimming, step dimming and daylight motion sensor, emergency available
- Limited Warranty: 10 Years, 100,000-hour at 25°C
- Operating temperature: -40°C to 45°C, -40°F to 113°F
- Beam angle: 120°
- DLC Color: 2700k, 3000k, 3500k, 4000k, 4500k, 5000k, 5700k

SPECIFICATION FEATURES

Construction

Constructed of impact resistant, UV protected polycarbonate body with stainless steel clips. Wet location, IP65 rating achieved utilizing outdoor rated gaskets and waterproof connectors.

Thermal Management

The SB-TP series provides excellent thermal management using specially engineered modular design drawing heat away from critical components. This enables the Luminaires to withstand higher ambient temperatures without degrading LED life.

Electrical

LED driver and related electrical components are hard wired and mounted to the housing for optimal heat sinking and operating efficiency. 120- 277V or 200-480V 50/60Hz, 0-10V dimming driver is available to accommodate controls such as dimming and motion sensor step dimming. emergency available Operating temperature range of -40°C to 45°C, -40°F to 113°F

Mounting Options

Surface mounts or suspended mount clips are standard.

Compliance

cULus listed for Wet location -20°C- 45°C. DLC, lighting facts, FCC listed, RoHS compliant and LED modules comply with IESNA LM-79 and LM-80 standards.

Finish

0.16" thick PC cover features a UV filter and provides excellent resistance against discoloring. Comes standard in white.

Warranty

10-year limited warranty.

Optics

120° beam angle is perfect for uniformity.

Available in 3000K, 4000K, or 5000K LED color temperatures (CCT) minimum 83 CRI

DIMENSION

SB/TP

20W



40W

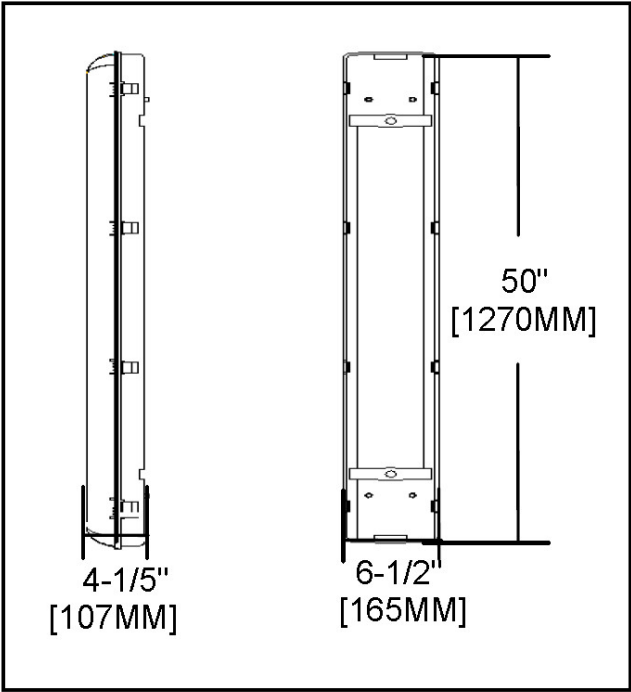
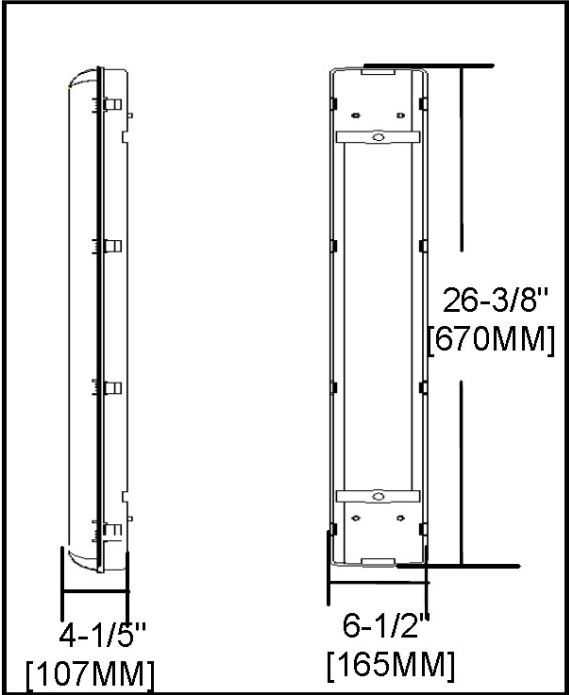

INSTALLATION OPTIONS: Surface mount clips, or suspended

CONTROLS:

SB/TP

**120-277VAC
PHOTOCONTROL**
Universal Voltage
photo controls.
Dust-to-dawn

Motion/Daylight Sensor on/off
Automatic switching based on motion and light level; the sensor supplies a simple energy-saving solution to use light only when and where you need it. It automatically switches on/off light based on motion and ambient light level

Operating voltage: 120-277Vac
Mounting height: 50 feet Max.
Detect ion area(R): 35 feet Max.
The operating temperature of the sensor is -95°F- 160°F

Motion/Daylight Sensor step dimming
1-10V interfaces.
Programmable 3 step dimming where detection area, time delay, output level and daylight threshold can be precisely set via programming.

Operating voltage: 120-277Vac
Mounting height: 50 feet Max.
Detect ion area(R): 35 feet Max.
The operating temperature of the sensor is -95°F- 160°F

* MODEL SELECTION: SB-TP TRI-PROOF

Example: SB/TP/F/2FT/20W/CW

Products series	Voltage	Cover	Length	Wattage	Kelvin	Options
SB/TP	*Blank=120-277 (standard)	*F=Frosted (standard)	*2FT=2FT	*20W=20w	WW=3000K	*Blank=Non-dimming
	C=347V	C=Clear	4 FT=4FT	40W=40w	NW=4000K	D=0-10V dimming
					*CW=5000K(standard)	

ACCESSORY ORDERING:

Item Accessory	MODEL NUMBER	DESCRIPTION
Option	SB-AMI	Internal Motion sensor & Daylight step dimming Sensor
	SB-EBP/4W	Factory installed Emergency Battery Pack 4w 90 minutes

LUMEN OUTPUT

GENERAL PERFORMANCE		
Wattage	KELVIN	DELIVERED LUMEN
20W	3000K	2400
	4000K	2600
	5000K	2750
40W	3000K	4900
	4000K	5100
	5000K	5250