

INSTALLATION INSTRUCTIONS AND OWNER'S MANUAL

CAUTION:
DAMAGE TO BATTERY MAY OCCUR
IF BATTERY IS CONNECTED TO
CHARGER BOARD FOR A PERIOD
EXCEEDING 24 HOURS WITHOUT
AC POWER PROVIDED.

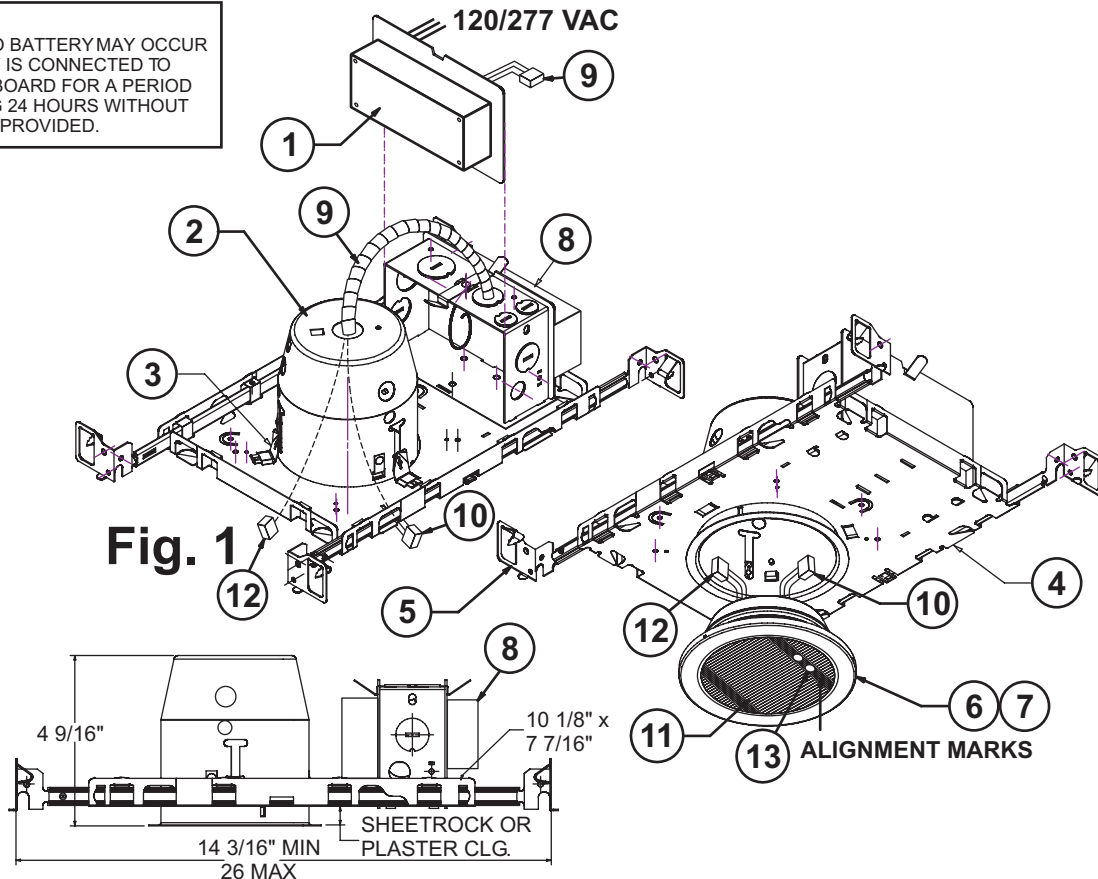

- See Fig 1. Insert three Retaining Clips (3) into Plaster Frame (5) and insert two Bar Hangers (5) into slots provided as shown.
- Install Plaster Frame assembly into ceiling. Make lamp housing cutout in ceiling plaster or tile.
- Insert Housing (2) and Lamp Cable Assembly (9) through ceiling cutout. Remove battery pack assembly from j-box for access and connect polarized Lamp Cable plug inside j-box.
- Run supply wiring to outlet box and make connections from AC building supply to input wiring from charger assembly:
BLACK: 120/277 VAC WHITE: NEUTRAL GREEN: GROUND
Connect polarized battery plug and replace battery pack assembly on to j-box.
- Raise Lamp Assembly to Housing and connect polarized lamp plug and test panel plug. Route wiring up into Housing and insert Lamp Assembly flush to ceiling panel.

NOTES (1): LAMPS WILL ILLUMINATE ON BATTERY POWER IF AC SUPPLY IS OFF. TO LIMIT BATTERY DISCHARGE, TURN AC POWER ON.
(2) LAMP ASSEMBLY MUST BE CORRECTLY ORIENTED WITH RESPECT TO PATH OF EGRESS. ROTATE LAMP ASSEMBLY SO THAT ALIGNMENT MARKS ARE IN LINE WITH THE PATH OF EGRESS.

6. Apply AC power and check test switch operation
SECURITY LIGHTING SWITCH CONTROL OPTION

To control security lighting mode, connect a 120 VAC/ 277 VAC supply with switch or timer across the BLUE and BROWN wires supplied from the power supply assembly. Power ON will activate security lighting mode, power OFF to deactivate.

SECURITY LIGHTING SWITCH CONTROL OPTION

Standard Models: To control security lighting mode connect a dry switch contact (no voltage input required) across the wires supplied. When the wires are connected security lighting mode will be activated. To turn OFF disconnect the dry contact.

DG Models: To control security lighting mode, connect a 120 VAC/ 277 VAC supply with switch or timer across the BLUE and BROWN wires supplied. Power ON will activate security lighting mode, power OFF to deactivate.

CONTINUOUS SEC LIGHTING

When set at the factory, no SEC control wiring is provided and fixture will operate in continuous SEC mode when AC power is applied. To set continuous SEC mode when control wiring is supplied:

Standard Models: Connect ORANGE-GREEN control wires together.

DG Models: Connect BLUE control wire to the normal AC input (BLACK) and connect the BROWN control wire AC neutral (WHITE).

IMPORTANT SAFEGUARDS READ AND FOLLOW ALL SAFETY INSTRUCTIONS

- Disconnect AC power before servicing.
- Refer to wiring diagram for proper connections.
- All servicing should be performed by qualified personnel.
- Consult your local building code for approved wiring and installation.
- Do not use outdoors.
- Do not use this equipment for other than intended use.
- Do not let power cords touch hot surfaces.
- Mount and secure the fixture at a location and height to avoid ready access and tampering by unauthorized persons.
- The use of accessory equipment is not recommended by the manufacturer and may cause an unsafe condition.

SAVE THESE INSTRUCTIONS