



SKYLINE HTM INSTALLATION INSTRUCTIONS

MODELS: All SAS & SAM Fixtures

1. Introduction

- Tools Needed:
Drill with Philips Head Bit or Philips Head Screwdriver
Socket Wrench with 3/16" Allen Head Bit

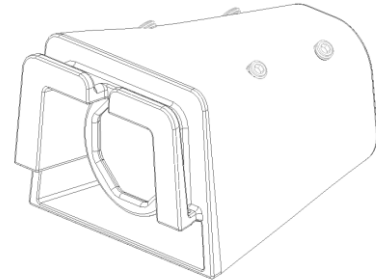

Warning:

To avoid the risk of fire, explosion, or electric shock, this product shall be installed, inspected, and maintained by a qualified electrician, in accordance with all applicable electrical codes.

Warning:

To avoid electric shock:

- Allow product to cool before servicing.
- Be certain electrical power is OFF before and during installation or maintenance.
- Luminaire must be connected to a wiring system with equipment-grounding conductor.

2. Installation

FIG.1

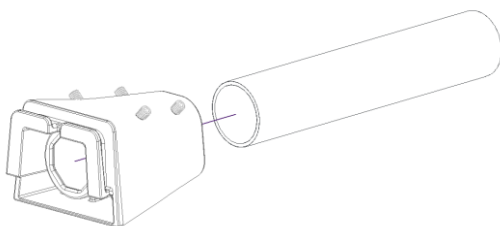
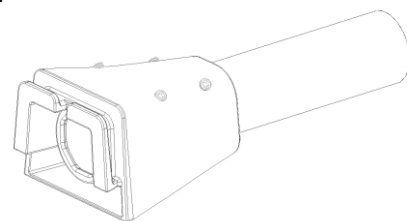

FIG.2



Step 1.

Locate the (4) set screws on the HTM and loosen them before installing on the Tenon. (FIG.1) Slide the HTM onto the Tenon and align so it sits straight and level. Tighten all set screws to hand tight first, then torque set screws to 20 ft-lbs (240 in-lbs) Check HTM is fully secure before proceeding. (FIG.2)

ILP

519 Codisco Way, Sanford, FL 32771
Phone: (407) 478 3759 Fax: (407) 478 3760
www.ilp-inc.com

Step 2

Open the driver door to the Skyline fixture and align with the HTM bracket. Slide the fixture down over the HTM bracket channel so that the fixture and bracket are flush. (FIG.3) Attach the (2) provided 8/32" screws through the HTM bracket bottom to secure the Skyline fixture. Tighten screws to 10 ft-lbs (120 in-lbs). (FIG.4)

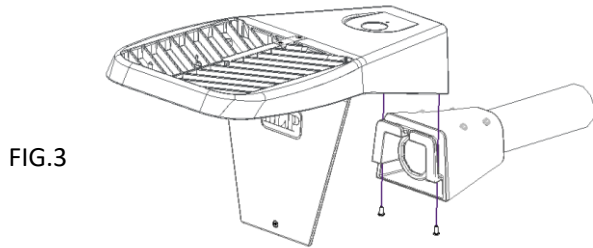

FIG.3

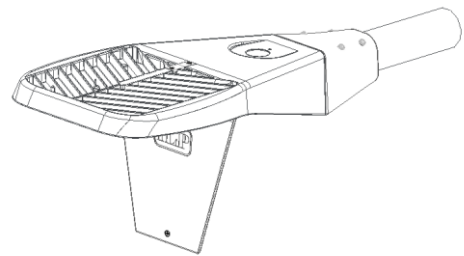

FIG.4

Step 3

Route wires located in driver compartment through supplied grommet and make the necessary wiring connections. (FIG.5) Close driver door and secure with reused 8/32" screw and tighten to 10 ft-lbs (120 in-lbs). (FIG.6)

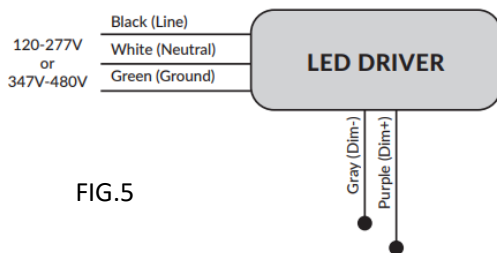

FIG.5

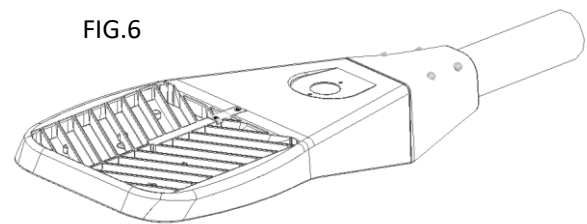

FIG.6

After installation, please

- Ensure the fixture is firmly secured to the pole. Turn the power on and check for proper operation of luminaire.

ILP

519 Codisco Way, Sanford, FL 32771
Phone: (407) 478 3759 Fax: (407) 478 3760
www.ilp-inc.com