

PROJECT NAME:	
CATALOG NUMBER:	FIXTURE TYPE:
VOLTS/WATTS:	LAMPS/BOARD:



CONVERSION WRAP - 40W LED

COMMERCIAL

72,000 Hour Estimated L70 Life ⁽¹⁾

73 lm/W Delivered

FEATURES

- 4 Foot Configuration
- Suitable for Continuous Runs
- 23 Ga Die Formed Steel Housing
- Specification Grade for New Construction
- Surface Mount or Suspended
- Ample KOs on Back and Ends.
- Prismatic Wrap Around Lens
- Wire Cage Option Available
 - Replaces Prismatic Lens
- Multiple Dimming and Sensor Options to Fully Control Occupied and Unoccupied Light Levels
- 5 Year Warranty
- ETL Damp Listed



LED SYSTEM

Board (Nichia Chips)	1 x 36
Calculated L70 (TM-21)	72,000 hours
Delivered Lumens	3,386 lm
Total Input Watts	46.47 W
Luminaire Efficacy Rating (LER)	72.86 lm/W
Correlated Color Temperature (CCT)	5000 K
Color Rendering Index (CRI)	> 80
Max Ambient Temp	120° F
Universal Dimmable Driver	120-277 V

⁽¹⁾ LED Lumen Maintenance Estimates based on TM-21 projections for the light source at 25°C ambient

SUITABLE APPLICATIONS

- Work Station Task Lighting
- Offices
- Hallways
- Multi Purpose



ORDERING GUIDE:

FWC	40WLED	UNIV	5000K	eg: MCWHIP6 - WW	
Series	LED	Driver	Color	Options	
<input type="checkbox"/> FWC Conversion Wrap 4ft	<input type="checkbox"/> 40WLED 1x36 Boards	<input type="checkbox"/> UNIV 120-277 Driver	<input type="checkbox"/> 3000K* <input type="checkbox"/> 4000K <input type="checkbox"/> 5000K	<input type="checkbox"/> CORDX Cord (X = ft) <input type="checkbox"/> PLUGX Plug (X = Type, eg. L715P) <input type="checkbox"/> LEDBB LED Battery Backup (may reduce max ambient) <input type="checkbox"/> MCWHIPX Flexible Conduit (X = ft) <input type="checkbox"/> SD480 480V Step Down Transformer <input type="checkbox"/> WC Wire Cage (Replaces Prismatic Lens) <input type="checkbox"/> DIM 0-10V Dimmable Driver <input type="checkbox"/> FIOS Factory Installed Occupancy Sensor <input type="checkbox"/> USDC User Selectable Dimming Control <input type="checkbox"/> USBD User Select Bi-level Dim w/ Occ. Sensor <input type="checkbox"/> BDxx Bi-level Dimming (xx=% - eg. 10%, 20%, 30%...)	

*Call for Availability

CONVERSION WRAP - 40W

COMMERCIAL

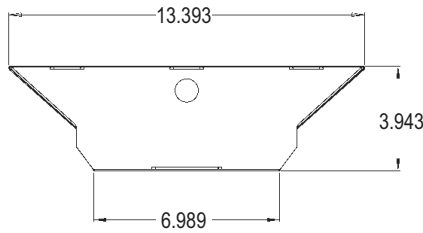

FWC
Conversion Wrap

MOUNTING OPTIONS

SURFACE MOUNT

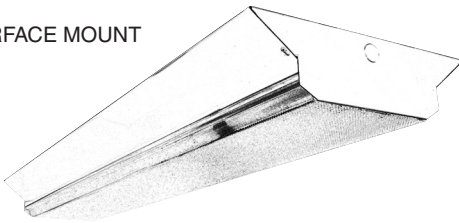

FWC-40WLED-UNIV

LUMINAIRE OUTPUT = 3382 LMS
120VAC, 387.70mA 46.470W, 0.9980PF

SUMMARY DATA

HEMISPHERES TESTED:	BOTH
EFFICIENCY (Total):	100.0 %
EFFICIENCY (Down / Up):	97.8 % / 2.2 %
EFFICIENCY (Street / House):	52.7 % / 47.3 %
ROADWAY CLASSIFICATION:	TYPE VS
CUTOFF CLASSIFICATION:	SEMICUTOFF
LUMENS/LAMP:	3385.439
NO. OF LAMPS:	1
LUMINOUS OPENING: RECTANGULAR	
Width:	4.00 (Feet)
Length:	0.67
Height:	0.00
INPUT WATTS:	46.5

PLANE AND CONE DIAGRAM

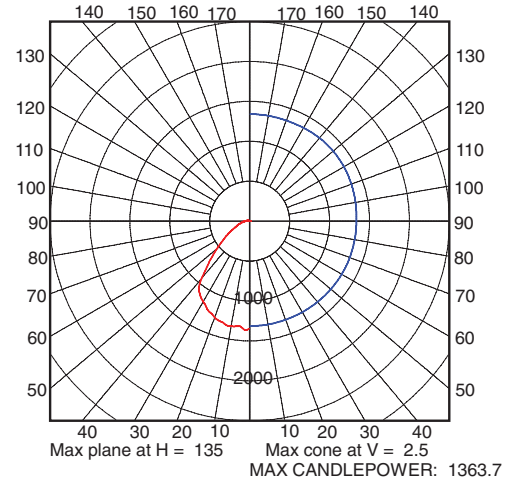

Photometric values based upon tests performed in compliance with LM-79. IES files can be downloaded at www.ilp-inc.com

LED

Industrial Lighting Products

lighting facts®
A Program of the U.S. DOE

Light Output (Lumens)	3386
Watts	46.47
Lumens per Watt (Efficacy)	72

Color Accuracy
Color Rendering Index (CRI) 71

Light Color
Correlated Color Temperature (CCT) 5083 (Daylight)

Warm White

Bright White

Daylight

2700K

3000K

4500K

6500K

All results are according to IESNA LM-79-2008: *Approved Method for the Electrical and Photometric Testing of Solid-State Lighting*. The U.S. Department of Energy (DOE) verifies product test data and results.

Visit www.lightingfacts.com for the **Label Reference Guide**.

Registration Number: 8QYC-M4VF85 (9/24/2012)
Model Number: FWN-40WLED-UNIV-PLUG
Type: Surface-mounted fixture (other)