



SENSORWORX®

# LOW VOLTAGE MOMENTARY SWITCH & 0-10V DIMMER

INSTALLATION & OPERATION INSTRUCTIONS



## SPECIFICATIONS

### ELECTRICAL

**OPERATING VOLTAGE**

5-24 VDC

**CURRENT DRAW**

2mA

**DIMMING LOAD** (Model # SWX-803 only)

50mA, (0-10 VDC ballasts or drivers compliant with IEC 60929 Annex E.2)

**MOMENTARY PULSE LENGTH**

250 msec

### PHYSICAL

**SIZE**

2.74"H x 1.68"W x 1.39"D

(6.96 x 4.27 x 3.53 cm)

Fits Decorator Switch Plate Opening

**DEPTH IN WALL**

0.94" (23.88 mm)

**WEIGHT**

2.5 oz

**MOUNTING**

Single Gang Switch Box

### ENVIRONMENTAL

**OPERATING TEMP**

32°F to 122°F (0°C to 50°C)

**RELATIVE HUMIDITY**

0-95% Non-Condensing,  
Indoor Use Only

**CATALOG NUMBERS****DESCRIPTIONS**

SWX-801-xx

LOW VOLTAGE MOMENTARY SWITCH

SWX-803-xx

LOW VOLTAGE 0-10V DIMMING SWITCH

## OVERVIEW

The **SENSORWORX** low voltage decorator wall station functions as a momentary switch with a pulse length of 250 msec. Typically, it is utilized along with any **SENSORWORX** power pack with the auxiliary switch input option (e.g. model SWX-900-AX). Using a four-conductor low voltage wire (typically 18 AWG), low voltage power, common, and relay status is wired from the power pack to the switch. The switch output is then wired back to the power pack's auxiliary switch input. For applications requiring Vacancy (e.g., Manual On) operation, the switch signals the power pack to turn on lighting after the unit's button is pressed. To achieve multi-way switching, two or more single button units can be wired in parallel.

For three button units with integrated dimming, an additional 0-10V output wire is provided to connect directly to fixtures. By default, the lights will always come on to the last dim level, however the unit can be programmed to turn-on to a preset level in order to accommodate partial-on applications.



## FEATURES

- Decorator Style Fits Common Wall Plates (not included)
- Less than 1" Depth in Wall
- Multi-way Switching Capable (e.g., 3-way, 4-way)
- Intuitive Operation
- Matches Styling of SWX Wall Switch Sensor
- Locator LED when Lights are Off
- Modern Look and Intuitive Easy-Tap Button for On/Off, Raise, & Lower
- Five Segment LED Indication of Dim Level
- Configurable Dimming Parameters (High/Low Trims, Turn on Levels, Fade Rates, and Curve Types)
- Settings are Adjustable Without Removing Cover Plate

# WIRING

## STANDARD WIRING

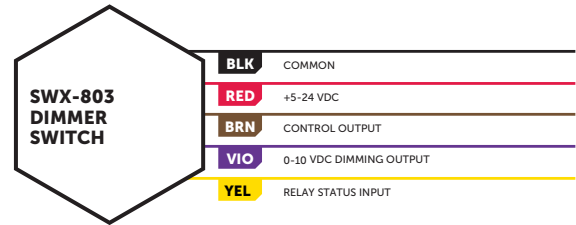
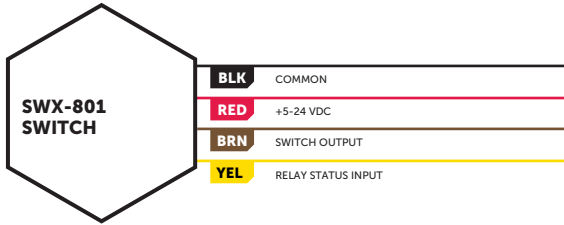

## MANUAL ON APPLICATION (VACANCY)

- Default operation of the SWX-900-AX is Automatic On (Occupancy) operation. For proper vacancy operation, the SWX-900-AX's OPERATIONAL MODE setting needs to be configured for MANUAL ON (VACANCY).
- Additional SWX-801 switches can be wired in parallel to achieve 3-way (or more) operation.

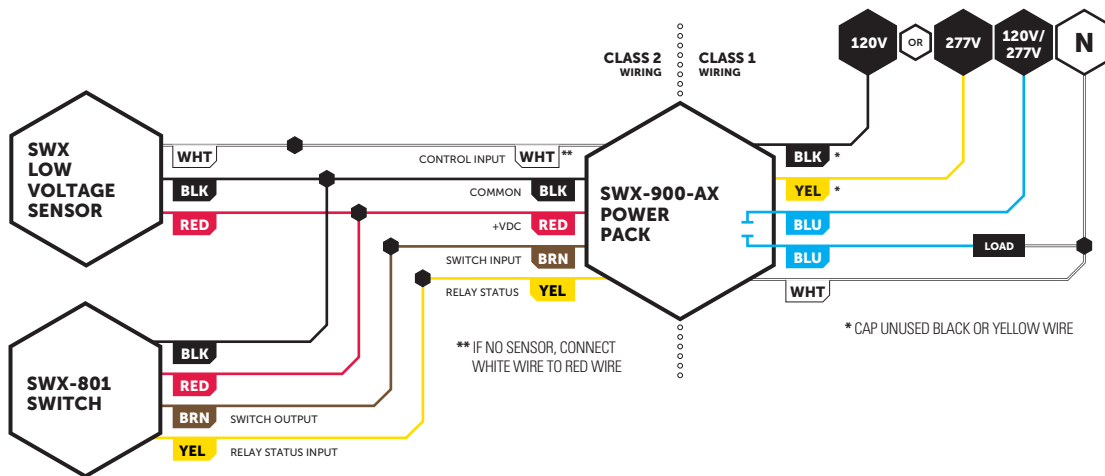

## MANUAL ON (VACANCY) OR PARTIAL-ON w/ FULL DIMMING CONTROL

- Lights turn on to last selected level (default) or to preset level (e.g., partial on).
- If no sensor is present, tie power pack low voltage red to low voltage white wire.
- Default operation of the SWX-900-AX is Automatic On (Occupancy) operation. For proper vacancy or partial-on operation, the SWX-900-AX's OPERATIONAL MODE setting needs to be configured for MANUAL ON (VACANCY).

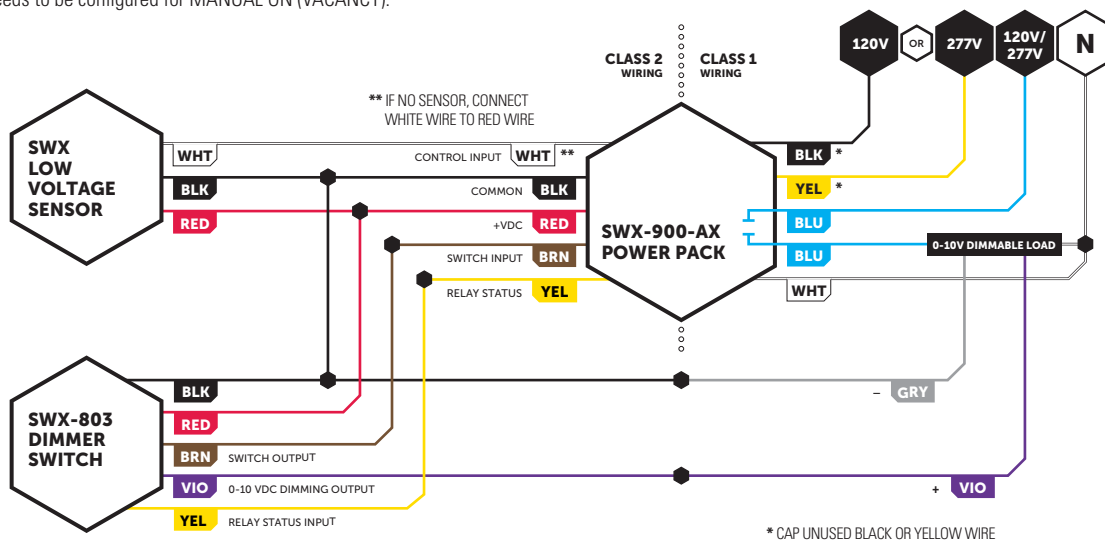

# INSTALLATION

Designed to mount in 1-gang wall box with 3.28" hole spacing. Units can also share multiple gang wall boxes with other devices.

## FRONT

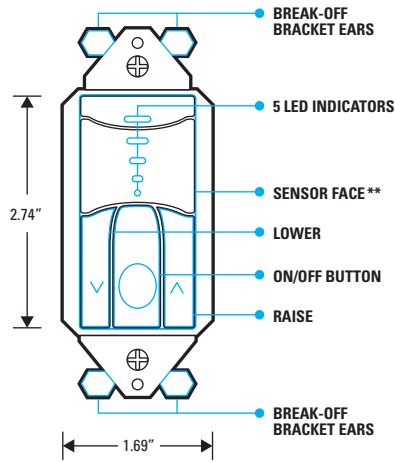
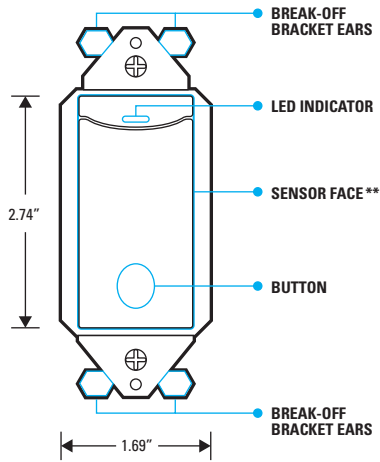

## SIDE

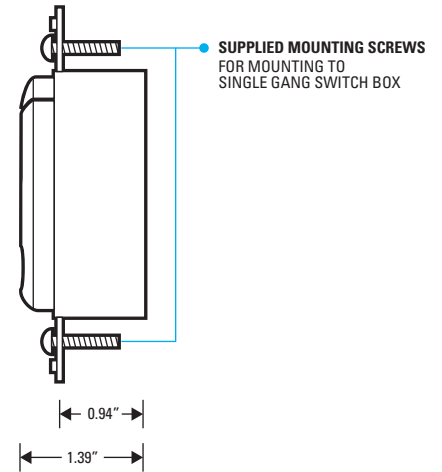

\*\* SENSOR FACE IS FIELD REMOVABLE IN ORDER TO CHANGE COLORS. CONTACT FACTORY FOR ADDITIONAL FACES

# CONFIGURATION SETTINGS

## CONFIGURATION PROGRAMMING

- 1 From the lists of Configuration Functions below, note the Button Position and number (#) of the Function to be changed. For example, HIGH TRIM setting is the Right Button, #3.
- 2 Enter programming mode by pressing and holding the CENTER button until the blue LED begins rapid flashing.
- 3 Press and release the applicable button for the chosen function. For example, press the RIGHT button 3 times for the HIGH TRIM setting.
- 4 The LED will flash back the setting number of the current value as it appears in each function's detailed table of values (see following pages). For example, the default HIGH TRIM is setting #2 (10V) for the RIGHT button.
- 5 Press and release the applicable button the number of times equal to the new setting #. For example, RIGHT button 3 times (for 9V).
- 6 The LED will flash back the new setting number as confirmation.
- 7 To save and exit programming mode, press and hold the function's applicable button again until the LED flashes rapidly. The LED will then blink white twice as confirmation of success.

NOTE IF THE LED DOUBLE FLASHES TWICE BLUE AT ANY POINT, REPEAT THE ABOVE PROCEDURE.

## CONFIGURATION FUNCTIONS

### LEFT BUTTON

#### DIMMING

| FUNCTION NAME   | BUTTON POSITION | FUNCTION # |
|-----------------|-----------------|------------|
| Turn Off Scheme | Left            | 2          |
| Low Trim        | Left            | 3          |
| Fade Off Time   | Left            | 4          |

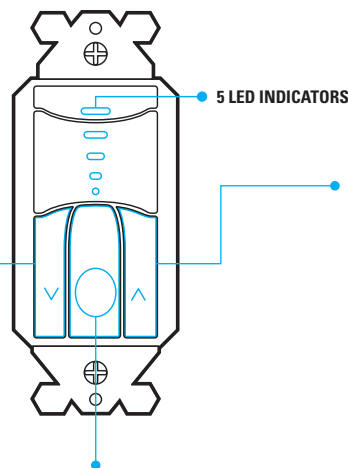

### RIGHT BUTTON

#### DIMMING

| FUNCTION NAME         | BUTTON POSITION | FUNCTION # |
|-----------------------|-----------------|------------|
| Turn On Dimming Level | Right           | 2          |
| High Trim             | Right           | 3          |
| Fade On Time          | Right           | 4          |
| Dimming Curve Type    | Right           | 5          |

### CENTER BUTTON

| FUNCTION NAME | BUTTON POSITION | FUNCTION # |
|---------------|-----------------|------------|
| LED           | Center          | 7          |
| Factory Reset | Center          | 8          |

# CONFIGURATION SETTINGS CONT.

## CENTER FUNCTION #7 LED FUNCTION

### CENTER BUTTON

Single button switch (SWX-801) has an LED that is white when lights are on and is a blue locator LED when lights are off. Dimming switch (SWX-803) has five white LEDs that indicate the current dim level. Locator LED can also be programmed to be white and/or brighter. Locator LED can also be disabled

| SETTING # | DESCRIPTION   | NOTES   |
|-----------|---|---------|
| 2         | White LED when lights on, blue locator LED when off, normal brightness    | Default |
| 3         | Blue LED when lights on, white locator LED when off, normal brightness    |         |
| 4         | All LED functionality disabled.   |         |
| 5         | White LED when lights on, blue locator LED when off, increased brightness |         |
| 6         | Blue LED when lights on, white locator LED when off, increased brightness |         |

## CENTER FUNCTION #8

### RESTORE FACTORY DEFAULTS

#### CENTER BUTTON

| SETTING # | DESCRIPTION              |
|-----------|--------------------------|
| 3         | Restore Factory Defaults |

## LEFT FUNCTION #2 TURN OFF SCHEME

### LEFT BUTTON

| SETTING # | VALUES   | NOTES                  |
|-----------|--|------------------------|
| 2         | Unit fades to low trim and signals relay to open   | Default for all models |
| 3         | Unit fades dimming output down to 0 volts (i.e. below a connected driver's electronic off level). Relay remains closed |                        |
| 4         | Unit fades dimming output down to low trim level. Relay remains closed   |                        |

## RIGHT FUNCTION #2 TURN ON DIMMING LEVEL

### RIGHT BUTTON

| SETTING # | VALUES                            | NOTES                          |
|-----------|-----------------------------------|--------------------------------|
| 2         | Fade on to 100% of High Trim      |                                |
| 3         | Fade on to 50% of High Trim       |                                |
| 4         | Fade on to last user level        | Default                        |
| 5         | Fade on to current (custom) level | Saves unit's current dim level |

## LEFT FUNCTION #3 LOW TRIM

### LEFT BUTTON

| SETTING # | VALUES                          | NOTES  |
|-----------|---------------------------------|--|
| 2         | Saves current level as low trim |  |
| 3         | 0%                              |  |
| 4         | 10% (Default)                   |  |
| 5         | 20%                             | Exact output voltage level depends on Dimming Curve selected (e.g. Linear, Log). Light output at each level depends on driver/ballast and luminaire. |
| 6         | 30%                             |  |
| 7         | 40%                             |  |
| 8         | 50%                             |  |

## RIGHT FUNCTION #3 HIGH TRIM

### RIGHT BUTTON

| SETTING # | VALUES                           | NOTES  |
|-----------|----------------------------------|--|
| 2         | Saves current level as high trim |  |
| 3         | 100% (default)                   |  |
| 4         | 90%                              | Exact output voltage level depends on Dimming Curve selected (e.g. Linear, Log). Light output at each level depends on driver/ballast and luminaire. |
| 5         | 80%                              |  |
| 6         | 70%                              |  |
| 7         | 60%                              |  |
| 8         | 50%                              |  |

## LEFT FUNCTION #4 FADE OFF TIME

### LEFT BUTTON

| SETTING # | VALUES   | NOTES                  |
|-----------|----------|------------------------|
| 2         | 0.75 Sec |                        |
| 3         | 1.5 Sec  | Default for all models |
| 4         | 3 Sec    |                        |
| 5         | 5 Sec    |                        |
| 6         | 15 Sec   |                        |

## RIGHT FUNCTION #4 FADE ON TIME

### RIGHT BUTTON

| SETTING # | VALUES   | NOTES                  |
|-----------|----------|------------------------|
| 2         | 0.75 Sec |                        |
| 3         | 1.5 Sec  | Default for all models |
| 4         | 3 Sec    |                        |
| 5         | 5 Sec    |                        |
| 6         | 15 Sec   |                        |

## LEFT FUNCTION #5 MANUAL DIMMING RESPONSE CURVE

### RIGHT BUTTON

| SETTING # | VALUES     | NOTES                  |
|-----------|------------|------------------------|
| 2         | Linear     | Default for all models |
| 3         | Log        |                        |
| 4         | Square Log |                        |