

# Lumination™ LED Luminaire

Linear Lighting

(ALM2-series)



## BEFORE YOU BEGIN

Read these instructions completely and carefully.

Read and follow appropriate Lumination LED Luminaire Installation Guide for fixture installation.

## IMPORTANT SAFEGUARDS

WHEN USING ELECTRICAL EQUIPMENT, BASIC SAFETY PRECAUTIONS  
SHOULD ALWAYS BE FOLLOWED INCLUDING THE FOLLOWING:

### READ AND FOLLOW ALL SAFETY INSTRUCTIONS

1. Turn power off before inspection, installation or removal.
2. To reduce the risk of electric shock, disconnect both normal and emergency power suppliers before servicing.
3. The emergency driver must be fed from the same branch circuit as the AC driver.
4. Do not attempt to service the battery. A sealed, no-maintenance battery is used that is not field replaceable. Contact the manufacturer for information on service.
5. Follow all NEC and local codes. Properly ground electrical enclosure.
6. Use only UL listed wire for input/output connections. Minimum size 18 AWG (0.75mm<sup>2</sup>).
7. Equipment should be mounted in locations and at heights where it will not readily be subjected to tampering by unauthorized personnel.
8. Do not use outdoors.
9. Do not mount near gas or electric heaters.
10. Do not use this equipment for other than intended use.
11. The use of accessory equipment not recommended by the manufacturer may cause an unsafe condition.
12. Use caution when servicing batteries. Battery acid can cause burns to skin and eyes. If acid is spilled on skin or eyes, flush acid with fresh water and contact a physician immediately.

### SAVE THESE INSTRUCTIONS

#### Ni-Cd Battery

The rechargeable Nickel-Cadmium battery in this product must be recycled or disposed of properly.

**This equipment is not self-testing in conformance  
with the Life Safety Code, ANSI/NFPA 101**



imagination at work

## WARNING/AVERTISSEMENT

### RISK OF ELECTRIC SHOCK

- Turn power off before inspection, installation or removal.
- Properly ground electrical enclosure.

### RISK OF FIRE

- Follow all NEC and local codes.
- Use only UL or IEC approved wire for input/output connections. Minimum size 18 AWG.

### RISQUES DE DÉCHARGES ÉLECTRIQUES

- Coupez l'alimentation avant d'inspecter, installer ou déplacer le luminaire.
- Assurez-vous de correctement mettre à la terre le boîtier d'alimentation électrique.

### RISQUES D'INCENDIE

- Respectez tous les codes NEC et codes locaux.
- N'utilisez que des fils approuvés par UL ou IEC pour les entrées/sorties de connexion. Taille minimum 18 AWG.

This device complies with Part 15 of the FCC Rules. Operation is subject to the following two conditions: (1) This device may not cause harmful interference, and (2) this device must accept any interference received, including interference that may cause undesired operation. CAN ICES-005 (A) / NMB-005 (A)

Note: This equipment has been tested and found to comply with the limits for a Class A digital device, pursuant to part 15 of the FCC Rules. These limits are designed to provide reasonable protection against harmful interference when the equipment is operated in a commercial environment. This equipment generates, uses, and can radiate radio frequency energy and, if not installed and used in accordance with the instruction manual, may cause harmful interference to radio communications. Operation of this equipment in a residential area is likely to cause harmful interference in which case the user will be required to correct the interference at his own expense.

## Prepare Electrical Wiring



### Electrical Requirements

The LED driver must be supplied with 120-277 VAC, 50/60 Hz per product label and connected to an individual properly grounded branch circuit, protected by a 15 or 20 ampere circuit breaker.



### Grounding Instructions

The grounding and bonding of the overall system shall be done in accordance with National Electric Code (NEC) Article 600 and local codes.

## Tools and Components Required

- ALM2-series fixture
- Mounting hardware (not Included)
- #2 Phillips screwdriver
- Drill

## Battery Backup Mounting Requirements

Product Description	Maximum Mounting Height
ALM2-0-A3-C-4-V-B-ST-N-W	19 ft.
ALM2-0-A3-W-4-V-B-ST-N-W	21 ft.

## Battery Backup Operation

The battery is capable of operating the LED load for a minimum of 90 minutes. The battery recharge time is 24 hours. After installation, the battery should be allowed to charge.

This lighting fixture should be tested regularly according to national and local code requirements. To test the battery, remove AC power or press and hold the indicator test switch. Take standard precautions against static discharge while operating indicator test switch.

## Unit Installation

- 1 For safety, turn off main power prior to installation.

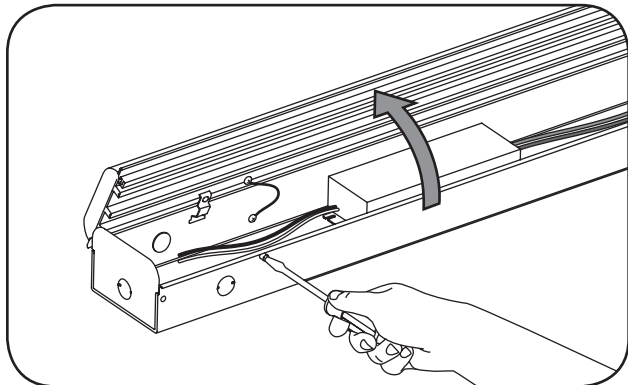

- 2 Before installation, loosen two screws on side of fixture, and open by holding lenses and sliding light engine away from screws.

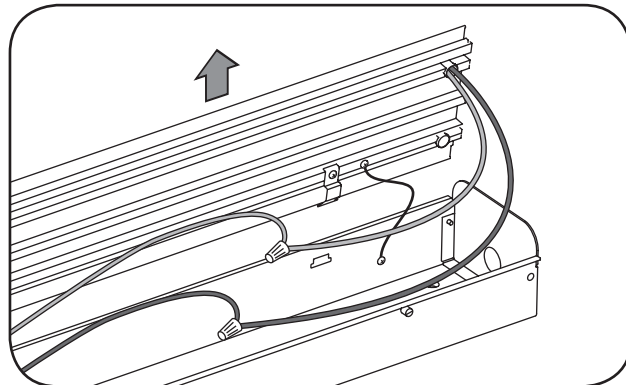

- 3 Remove light engine from box by rotating light engine 90° and sliding the plate towards the box until the hinges can be removed.

**NOTE:** Do not disconnect tethers, let aluminum extrusion with LEDs hang during installation.

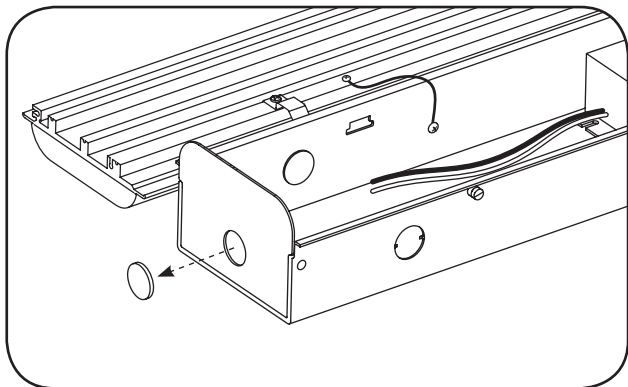

- 4 Remove appropriate knockout in fixture for power input.

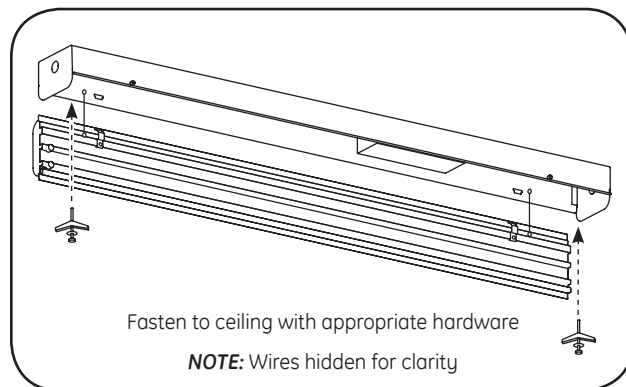

- 5 Install box to intended surface using mounting holes on both ends of fixture with appropriate mounting hardware. If mounting into a joist, use 2 wood screws and 2 washers to attach to joist. If joist is not available, use 2 toggle bolts and 2 washers to attach to plasterboard.

**NOTE:** Maximum mounting height:

- a) 19 ft. for Models ALM2 Series provided with 2 LED strips.
- b) 21 ft. for Models ALM2 Series provided with 4 LED strips.

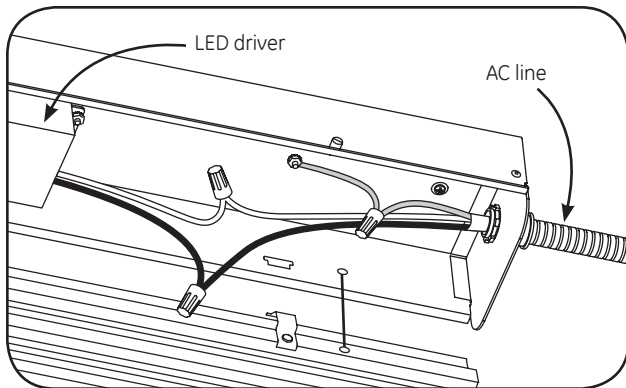

- 6** Connect the black (line) and white (neutral) wires of the AC line to the similarly colored wires of the fixture's LED driver using UL listed wire connectors. Connect the green (ground) to the lug inside the fixture.

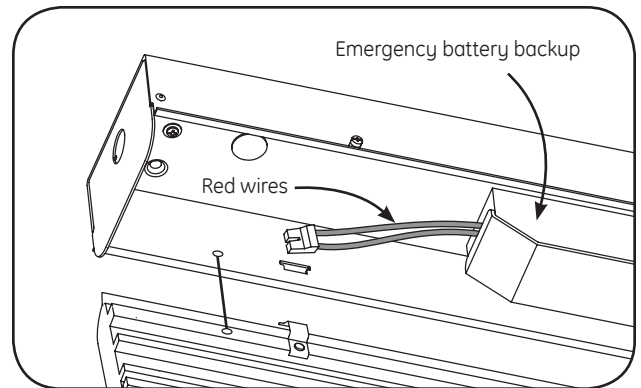

- 7 Optional:** If emergency battery backup is present, connect the two red wires together to activate.

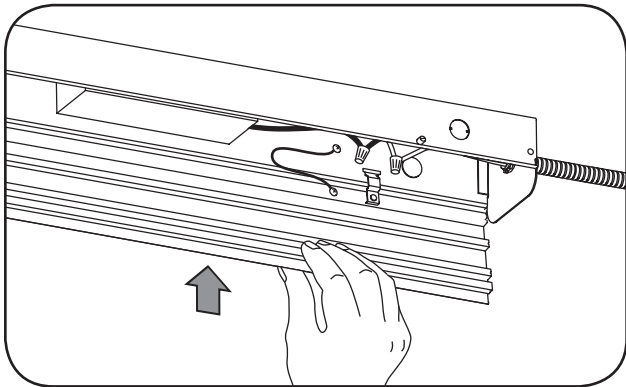

- 8** Reinsert the light engine into the box so that it is hanging open by the hinges.

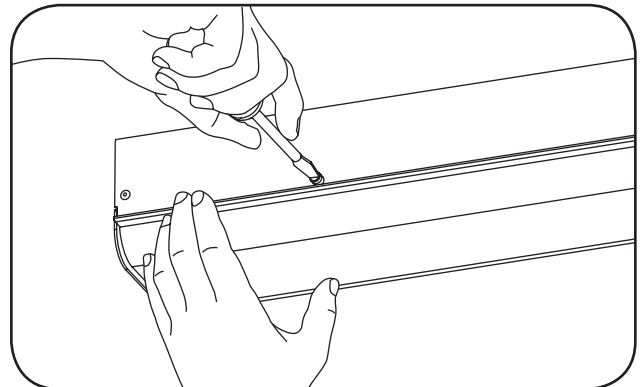

- 9** Tuck wires inside and close light engine. Reinsert screws into light engine on side of fixture making sure to pull the light engine firmly against the screw side of box.



- 10** Restore main power.



[www.gelighting.com](http://www.gelighting.com)

GE and the GE Monogram are trademarks of the General Electric Company. All other trademarks are the property of their respective owners. Information provided is subject to change without notice. All values are design or typical values when measured under laboratory conditions. GE Lighting is a business of the General Electric Company. © 2017 GE.

IND212 (Rev 09/07/17)